

DATE	SYM.	REVISION RECORD	AUTH.	DR.	CHK.
10/24/07	A	QTY. CHANGED FOR 1G, 1B, 1E, 71C.			829

CERTIFIED CORRECT
 BY 829
 DATE _____

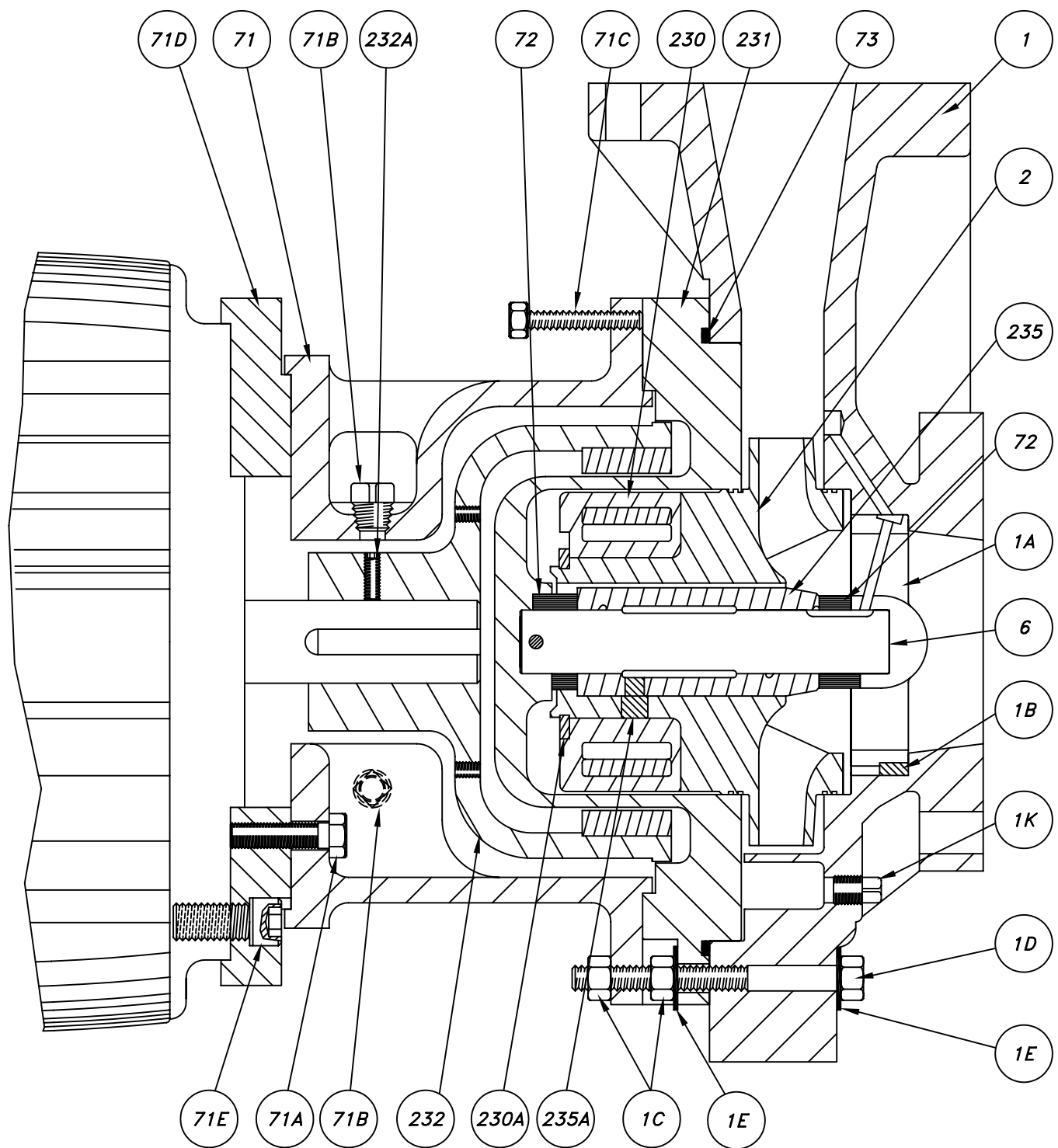

PART #	DESCRIPTION	QTY.	MATERIAL
1	CASING	1	VINYL ESTER
1A	WEB, SHAFT SUPPORT	1	VINYL ESTER
1B	PIN, CASING	1	VINYL ESTER
1C	NUT, CASING	16-32	303 S.S.
1D	BOLT, CASING	8-16	303 S.S.
1E	WASHER, CASING	16-32	303 S.S.
1K	PLUG, DRAIN (opt.)	1	TEFLON
2	IMPELLER	1	VINYL ESTER
6	SHAFT	1	SIL CAR
71	ADAPTER	1	CAST IRON
71A	SCREW, ADAPTER	4	303 S.S.
71B	PLUG, ADAPTER	2	STEEL
71C	JACK SCREW, ADAPTER	3-4	303 S.S.
71D	MOTOR ADAPTER (if req.)	1	CAST IRON
71E	SCREW, MOTOR-ADAPTER (if req.)	4	303 S.S.
72	BEARING, THRUST	2	SIL CAR
73	O-RING, SHELL	1	VITON
230	MAGNET ASSY., INNER	1	VINYL ESTER
230A	RETAINING RING	1	VINYL ESTER
231	SHELL, COVER	1	VINYL ESTER
232	MAGNET ASSY., OUTER	1	CAST IRON
232A	SET SCREW	2	STEEL
235	BEARING, SLEEVE	1	SIL CAR
235A	PIN, BEARING	1	VINYL ESTER

Fybroc Division TELFORD, PA 18969

2530 & 2580 GROUP 2 SCALE ~ DRAWN BY 829 APPROVED BY

TITLE SECTIONAL DRAWING

DATE 1/25/00 DRAWING NUMBER C50108-M REV. A